

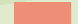





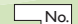

Key

-  20mph zone boundary
-  Main Public Transport and traffic routes to remain at existing speed limit
-  Existing 20mph zone
-  Property number e.g. 12
-  Zone entry/exit point with '20' signs and red surfacing
-  Zone entry/exit point with '20' signs
- TCF No.** Traffic Calming Feature
  -  Speed cushion
  -  Existing traffic calming feature

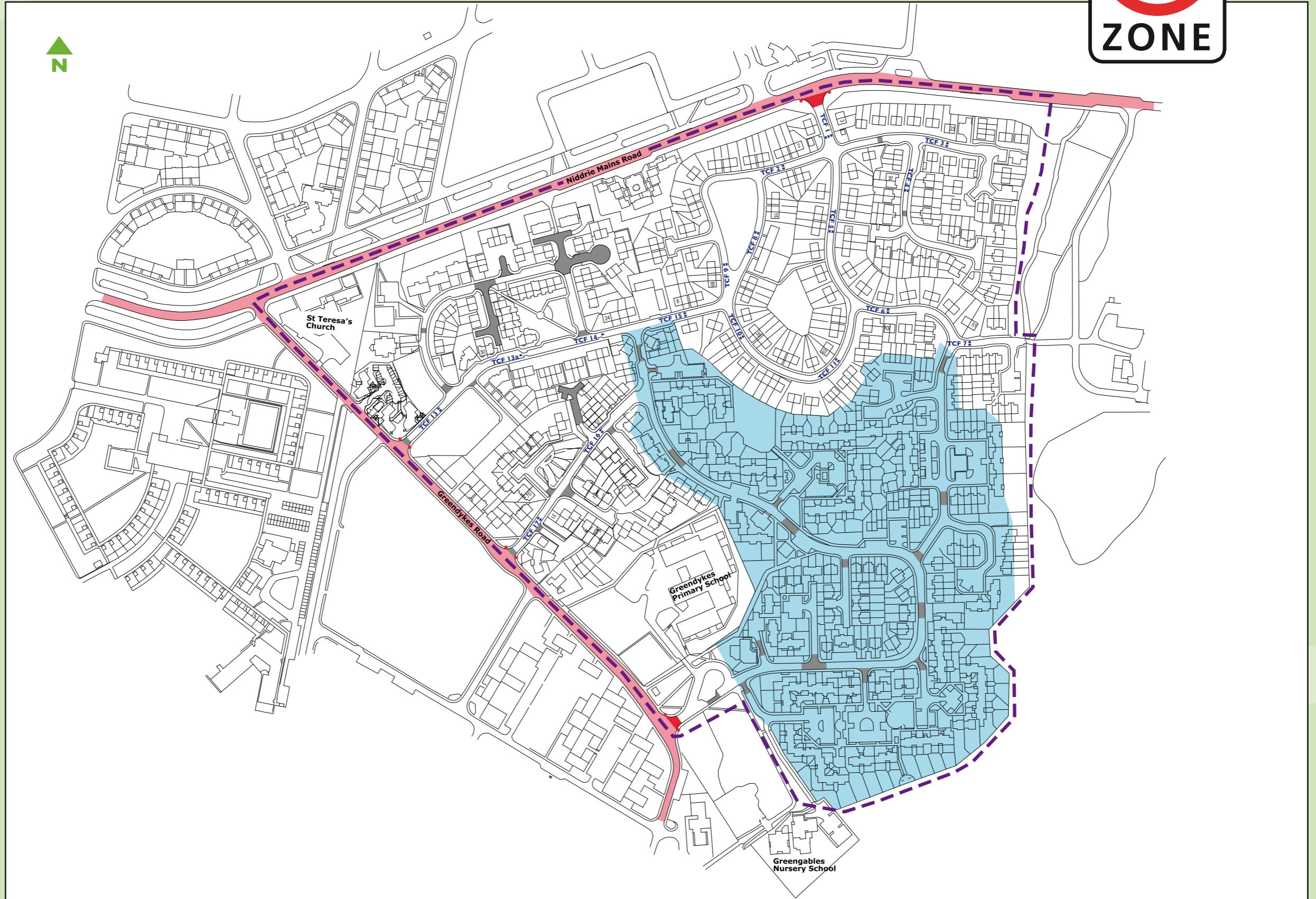

Safer to walk



Safer to cycle



Safer to drive